



Home & Land Package

245 Homestead Road Oamaru
\$989,000

The Reidston

3  2  2  2 
188m²  1.13ha 

Features:

- Walk-in scullery
- Flexibility of second lounge or 4th bedroom
- Family bathroom with bathtub
- Generous ensuite bathroom and walk-in wardrobe
- Sheltered North-West facing patio
- Brick and JSC Taiga timber cladding
- Gable roofline
- The Full Service includes earthworks, council & architect fees, interior design consultation, landscaping including driveway, footpaths, patio & lawn
- Anything you'd like to add? We've got this.

027 364 5921
03 434 8660
info@mcbrimar.co.nz

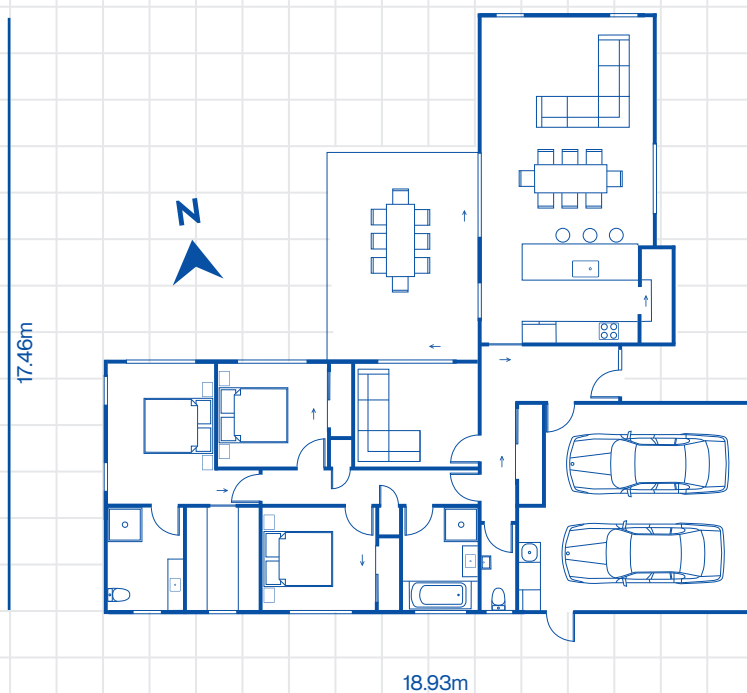

© McBrimar | Pricing valid until 31 August 2025