



Artist's impression

McBRIMAR 148



House size:
148m²

FEATURES

- North/West facing
- Open plan kitchen, dining and living room
- Indoor-outdoor flow
- Master ensuite with tiled wet floor shower
- Generous sized bedrooms
- Heat pump
- Internal access garage

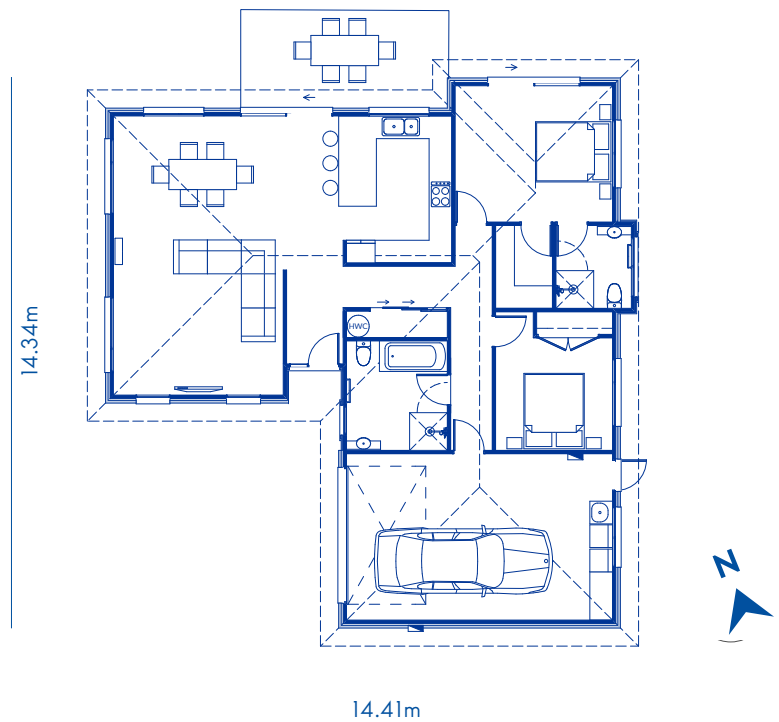

© McBrimar Homes



CONTACT US

03 434 8660 | info@mcbrimar.co.nz | mcbrimar.co.nz

MCBRIMAR
HOMES





Artist's impression

McBRIMAR 148+

2	2	2	1	1.5

House size:
148m²

UPGRADES CAN INCLUDE

- North facing window seat
- Fireplace
- Kitchen servery
- Skylight
- Gable roof line with render and oblique cladding

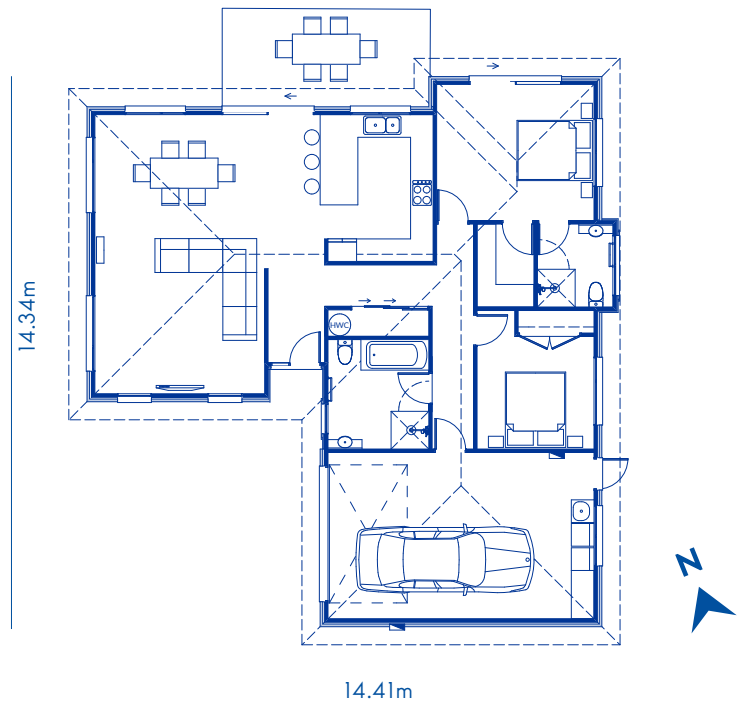

© McBrimar Homes



CONTACT US

03 434 8660 | info@mcbrimar.co.nz | mcbrimar.co.nz

